



SOLBERG

“MEGA BOY” FILTER SILENCERS

Single Barrel Filter Design

18” to 24” Flange, 5500 - 8000 SCFM

APPLICATIONS & EQUIPMENT

- ♦ Industrial & Severe Duty
- ♦ Centrifugal Blowers
- ♦ Piston Compressors
- ♦ Screw Compressors
- ♦ Centrifugal Compressors
- ♦ Fans
- ♦ Food Industry
- ♦ Pneumatic Conveying
- ♦ Waste Water Aeration
- ♦ Cement
- ♦ Power Plants
- ♦ Factory Air

FEATURES & SPECIFICATIONS

- ♦ Polyester: 99%+ removal efficiency standard to 5 micron
- ♦ Paper: 99%+ removal efficiency standard to 2 micron
- ♦ Heavy gauge base with low pressure drop bracket and outlet pipe design
- ♦ Durable carbon steel construction with baked enamel gray finish
- ♦ Low entry velocity air gap between base and cover
- ♦ Interchangeable media: Polyester, Paper, HEPA
- ♦ Tubular silencing design is positioned to maximize attenuation and air flow while minimizing pressure drop
- ♦ Temp (continuous): min -15°F (-26°C) max 220°F (104°C)
- ♦ Filter change out differential: 10”-15” H₂O over initial delta P
- ♦ Pressure drop graphs available upon request

OPTIONS (Inquiries Encouraged)

- ♦ 1/8” tap holes
- ♦ Pressure Drop Indicator
- ♦ Available in **Stainless Steel**
- ♦ Epoxy coated housings
- ♦ Various media
- ♦ FS, F, FT, MBF series styles

CONFIGURATIONS

DRAWING

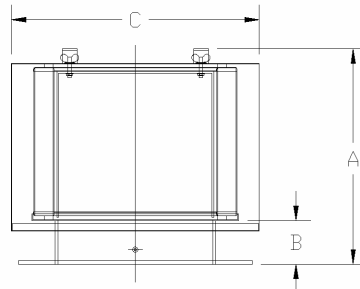

| | with Polyester Element | with Paper Element | Flg Outlet | Reference Only Dimensions - inches | | | Rated Flow SCFM |
|---|------------------------|--------------------|------------|------------------------------------|---|----|-----------------|
| | | | | A | B | C | |
| I | FS-391-1800F | FS-390-1800F | 18" | 23 1/2 | 6 | 44 | 5500 |
| S | FS-491-1800F | FS-490-1800F | 18" | 30 1/2 | 6 | 44 | 8000 |
| I | FS-491-2000F | FS-490-2000F | 20" | 30 1/2 | 6 | 44 | 8000 |
| I | FS-491-2400F | FS-491-2400F | 24" | 30 1/2 | 6 | 44 | 8000 |

Contact factory for other sizes, flows and for Filter Silencer configurations

